



ASKING PRICE

£299,000



## THE DETAILS



4



1



1



5 Mona Street

Peel

£299,000

call in today or visit [www.blackgracecowley.com](http://www.blackgracecowley.com) for more details

e: [peel@blackgracecowley.com](mailto:peel@blackgracecowley.com) | w: [blackgracecowley.com](http://blackgracecowley.com) | t: +44 (0) 1624 845 696

a: 9 Atholl Place, PEEL, Isle of Man, IM5 1HE

PROPERTY DETAILS FOR  
5 Mona Street, Peel



PROPERTY DETAILS FOR  
5 Mona Street, Peel



PROPERTY DETAILS FOR  
5 Mona Street, Peel



PROPERTY DETAILS FOR  
5 Mona Street, Peel





PROPERTY DETAILS FOR

## 5 Mona Street, Peel

### THE DESCRIPTION

- Well presented townhouse
- Conveniently situated in the heart of Peel and only a short walk to schools, shops and local amenities
- Porch, Entrance Hall
- Lounge/Diner, Breakfast Kitchen, Utility Room
- 4 double Bedrooms, Bathroom, Separate WC
- Rear yard with access

### THE PROPERTY

Black Grace Cowley are pleased to offer 5 Mona Street to the market. A well presented townhouse situated conveniently in the heart of Peel and only a short walk to schools, shops and local amenities. Entering the porch which leads into the bright and spacious hall way which provides access into the dual aspect lounge/diner with feature electric log burner. The bright breakfast kitchen can be found at the rear of the property which is fitted with a range of comprehensive units, door leading into the utility room which is plumbed for a washing machine and tumble dryer. Door leading out to the rear yard. On the first floor are two double bedrooms, family bathroom and separate WC. On the second floor are a further two double bedrooms.

At the rear of the property is a well maintained yard with access to a rear service lane. Gas fired central heating.

**e:** [peel@blackgracecowley.com](mailto:peel@blackgracecowley.com) | **w:** [blackgracecowley.com](http://blackgracecowley.com) | **t:** +44 (0) 1624 845 696

**a:** 9 Atholl Place, PEEL, Isle of Man, IM5 1HE

# FLOORPLAN

GROUND FLOOR  
519 sq.ft. (48.2 sq.m.) approx.

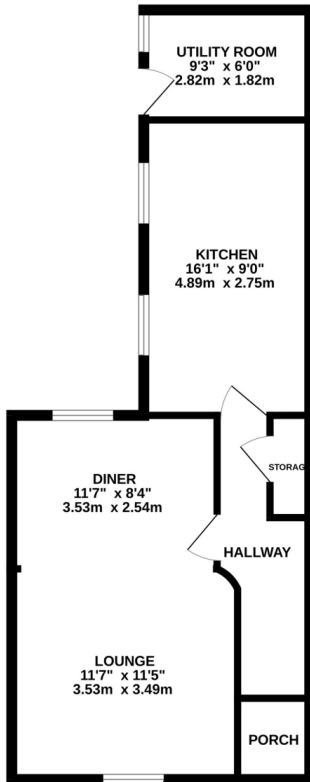

1ST FLOOR  
465 sq.ft. (43.2 sq.m.) approx.

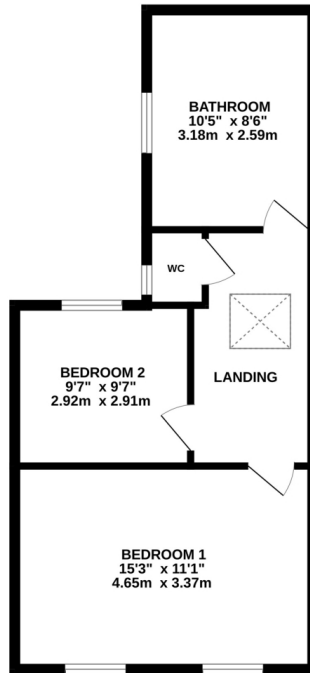

2ND FLOOR  
320 sq.ft. (29.8 sq.m.) approx.

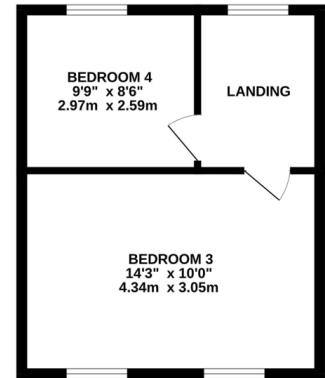

TOTAL FLOOR AREA: 1304 sq.ft. (121.2 sq.m.) approx.

Whilst every attempt has been made to ensure the accuracy of the floorplan contained here, measurements of doors, windows, rooms and any other items are approximate and no responsibility is taken for any error, omission or mis-statement. This plan is for illustrative purposes only and should be used as such by any prospective purchaser. The services, systems and appliances shown have not been tested and no guarantee as to their operability or efficiency can be given.  
Made with Metropix ©2023



PROPERTY DETAILS FOR

# 5 Mona Street, Peel

## Disclaimer

These particulars are for information purposes only and do not constitute or form any contract nor should any statement contained herein be relied upon as a representation of fact.

Neither the vendor nor Black Grace Cowley (the firm), nor any officer or employee of the firm accept liability or responsibility for any statement contained herein.

The vendor does not by these particulars, nor does the firm, nor does any officer or any employee of the firm have any authority to make or give any representation or warranty whatsoever as regards the property or otherwise. It is the sole responsibility of any person interested in the property described in these particulars to make all proper enquiries and searches to verify the description of the property and all other particulars herein.

**e:** [peel@blackgracecowley.com](mailto:peel@blackgracecowley.com) | **w:** [blackgracecowley.com](http://blackgracecowley.com) | **t:** +44 (0) 1624 845 696

**a:** 9 Atholl Place, PEEL, Isle of Man, IM5 1HE