



ASKING PRICE

£435,000



## THE DETAILS



5/6



4



1



14 Eastfield

Douglas

£435,000

call in today or visit [www.blackgracecowley.com](http://www.blackgracecowley.com) for more details

e: [hello@blackgracecowley.com](mailto:hello@blackgracecowley.com) | w: [blackgracecowley.com](http://blackgracecowley.com) | t: +44 (0) 1624 645555

a: 51 Victoria Street, DOUGLAS, Isle of Man, IM1 2LD



PROPERTY DETAILS FOR  
14 Eastfield, Douglas



e: [hello@blackgracecowley.com](mailto:hello@blackgracecowley.com) | w: [blackgracecowley.com](http://blackgracecowley.com) | t: +44 (0) 1624 645555

a: 51 Victoria Street, DOUGLAS, Isle of Man, IM1 2LD



PROPERTY DETAILS FOR  
14 Eastfield, Douglas





PROPERTY DETAILS FOR  
14 Eastfield, Douglas



PROPERTY DETAILS FOR  
**14 Eastfield, Douglas**





PROPERTY DETAILS FOR  
14 Eastfield, Douglas





PROPERTY DETAILS FOR

## 14 Eastfield, Douglas

### THE DESCRIPTION

- Well presented End of Terrace Townhouse
- Recently refurbished to an excellent standard with period features maintained
- Situated in a quiet position in the Town Centre of Douglas
- 5/6 Bedrooms, 3 En Suites, Family Bathroom
- Large open plan Lounge/Dining Room, Modern Kitchen
- Private courtyard, mature hedged front garden
- Electric heating, uPVC double glazed throughout
- Views up to Douglas Head and Kewaigue
- Offered for sale with no onward chain

### THE PROPERTY

Black Grace Cowley are delighted to offer this beautifully presented fully renovated end of terrace townhouse in a lovely quiet area in central Douglas with period features throughout, 5 double bedrooms plus study with 3 ensuite and a fourth family bathroom, large living/dining room with renovated manx stone fireplace and natural slate hearth carrying through to a good size new Howdens kitchen with solid oak worktops/breakfast bar with access to rear yard from kitchen and from dining room, low maintenance front and rear yard fully enclosed with access to the rear lane, fully re-wired and re-plumbed with all new heating system, new oak internal doors throughout, all new bathrooms fully fitted and with watertight vinyl wood effect flooring, master bedroom with built in sliding wardrobe doors and fitted shelving, all new pvc windows and doors, new carpet and herringbone flooring, generous and bright rooms throughout the whole house, top to bottom inside and outside freshly painted and finished to a high standard with no work needed just add furniture and enjoy. For Sale with no onward chain.

**e:** [hello@blackgracecowley.com](mailto:hello@blackgracecowley.com) | **w:** [blackgracecowley.com](http://blackgracecowley.com) | **t:** +44 (0) 1624 645555

**a:** 51 Victoria Street, DOUGLAS, Isle of Man, IM1 2LD

# FLOORPLAN

GROUND FLOOR  
789 sq.ft. (73.3 sq.m.) approx.

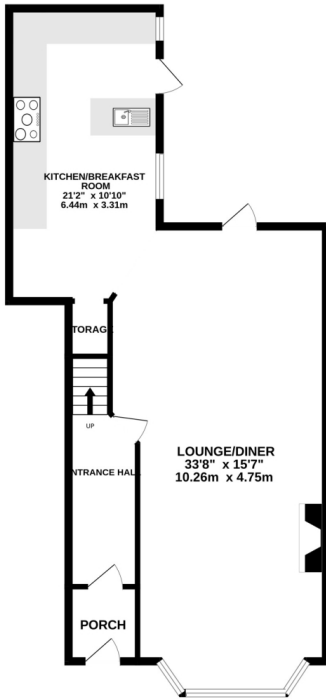

1ST FLOOR  
671 sq.ft. (62.3 sq.m.) approx.

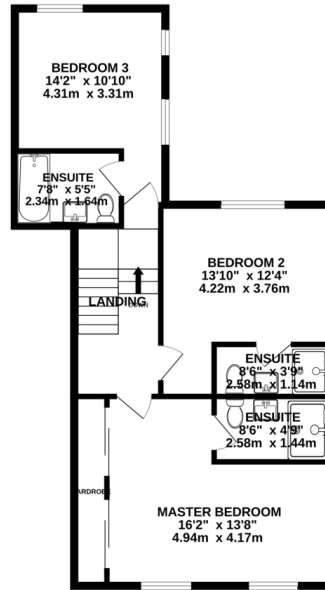

TOP FLOOR  
507 sq.ft. (47.1 sq.m.) approx.

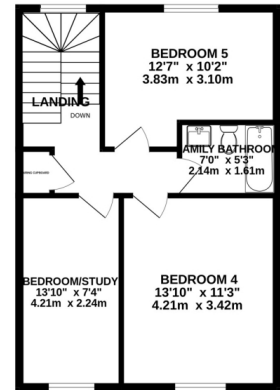

TOTAL FLOOR AREA: 1967 sq.ft. (182.7 sq.m.) approx.

Whilst every attempt has been made to ensure the accuracy of the floorplan contained here, measurements of doors, windows, rooms and any other items are approximate and no responsibility is taken for any error, omission or mis-statement. This plan is for illustrative purposes only and should be used as such by any prospective purchaser. The services, systems and appliances shown have not been tested and no guarantee as to their operability or efficiency can be given.

Made with Metropix ©2023





PROPERTY DETAILS FOR

# 14 Eastfield, Douglas

## Disclaimer

These particulars are for information purposes only and do not constitute or form any contract nor should any statement contained herein be relied upon as a representation of fact.

Neither the vendor nor Black Grace Cowley (the firm), nor any officer or employee of the firm accept liability or responsibility for any statement contained herein.

The vendor does not by these particulars, nor does the firm, nor does any officer or any employee of the firm have any authority to make or give any representation or warranty whatsoever as regards the property or otherwise. It is the sole responsibility of any person interested in the property described in these particulars to make all proper enquiries and searches to verify the description of the property and all other particulars herein.

**e:** [hello@blackgracecowley.com](mailto:hello@blackgracecowley.com) | **w:** [blackgracecowley.com](http://blackgracecowley.com) | **t:** +44 (0) 1624 645555

**a:** 51 Victoria Street, DOUGLAS, Isle of Man, IM1 2LD